



Babbington Close, Whittington

£395,000

3 1 3



A rare opportunity to acquire a beautifully presented and desirably located three bedroom home, nestling in the picturesque village of Whittington. This impressive end-of-terrace property in Babbington Close comes to the market with plenty of attractive features, from the flexible and generous choice of living space, to the very private garden with its own summerhouse.

Whittington is always incredibly sought after and it's no wonder as to why, with scenic surrounding countryside, highly rated schools, very easy access to Lichfield and other surrounding areas and the Birmingham and Fazeley canal just a short distance away. The accommodation is set across two floors, with an entrance porch, living room, stunning kitchen/diner, garden room, playroom and guest WC all to the ground floor, whilst the three good size bedrooms and tasteful bathroom occupy the first floor. A gravelled driveway is coupled with a fabulous rear garden that boasts a flexible summerhouse to complete the property's exterior.

Properties in Whittington tend to generate significant interest, so to combine this with the extensive list of fantastic features that the property itself is offering, we can only advise booking in a viewing at your earliest convenience.

We understand the property to be connected to mains gas, electricity, water and drainage.



ANDREW
DOWNING
BOOTH.
ESTATE AGENTS



ANDREW
DOWNING
BOOTH.
ESTATE AGENTS

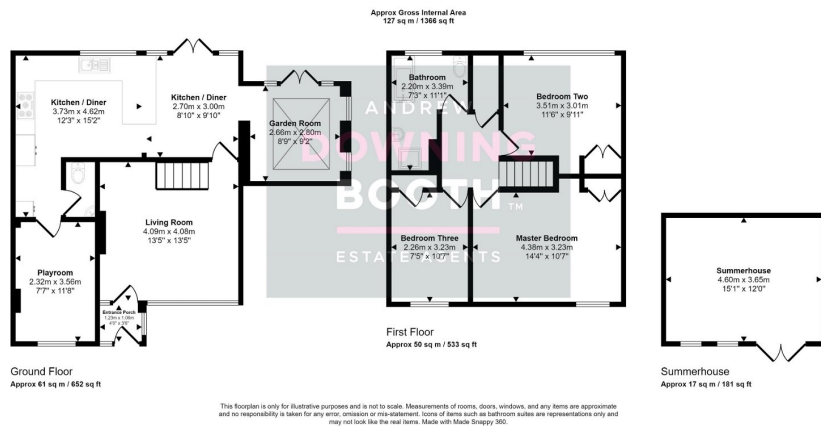

- Three Bedroom End Of Terrace Property
- Highly Desirable Village Location
- Stunning Kitchen / Diner With Garden Room
- EPC Rating: C
- Immaculately Presented Throughout
- Very Private & Attractive Garden With Summerhouse
- Quiet Tucked Away Position With Driveway
- Council Tax Band: C

